

AERIAL PHOTO
NTS

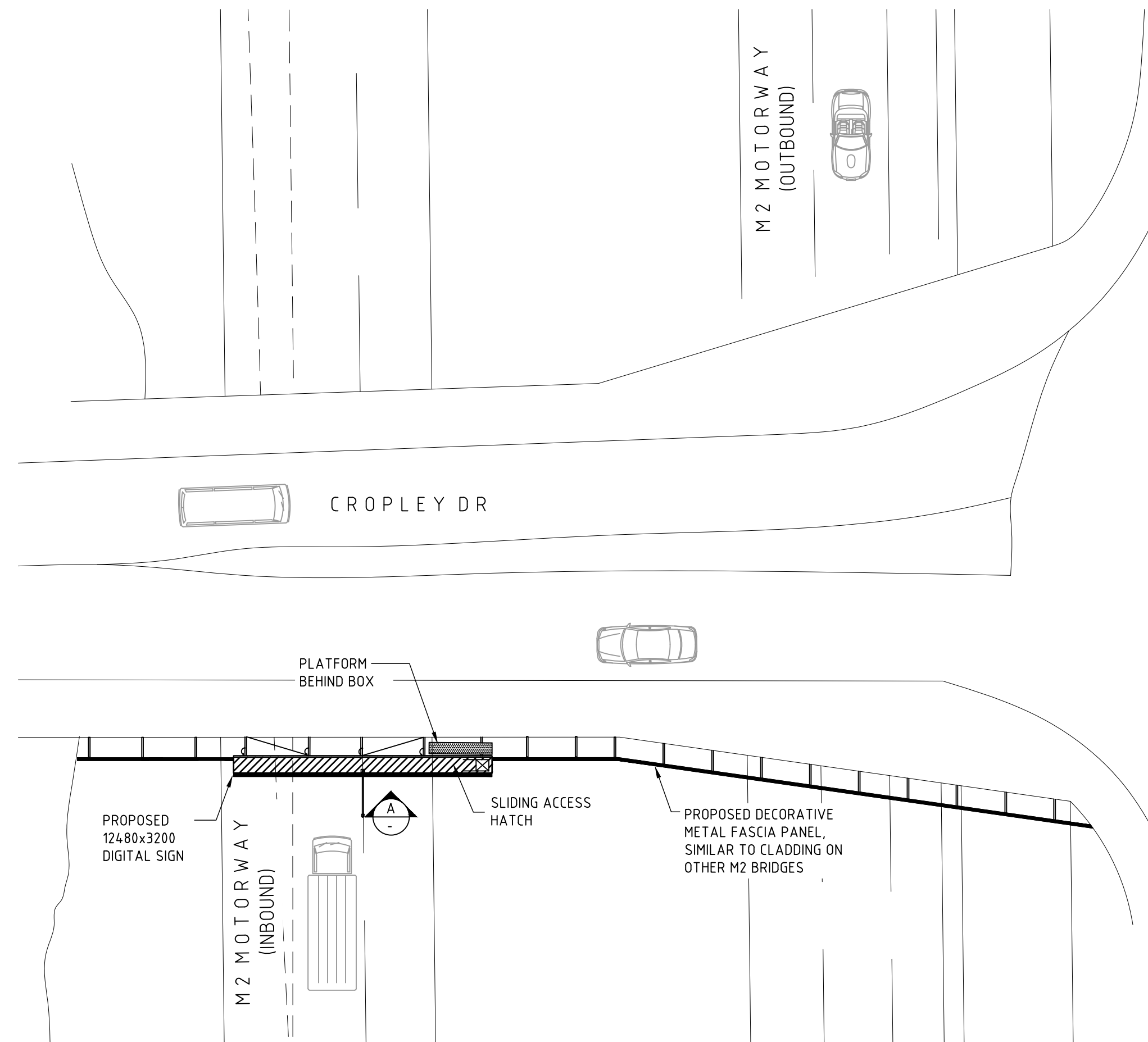

PROPOSED SITE PLAN
SCALE 1:200

RL'S ARE APPROXIMATE

FALL RESTRAINT CABLE TO BE FIXED BETWEEN SIGNBOX AND BRIDGE

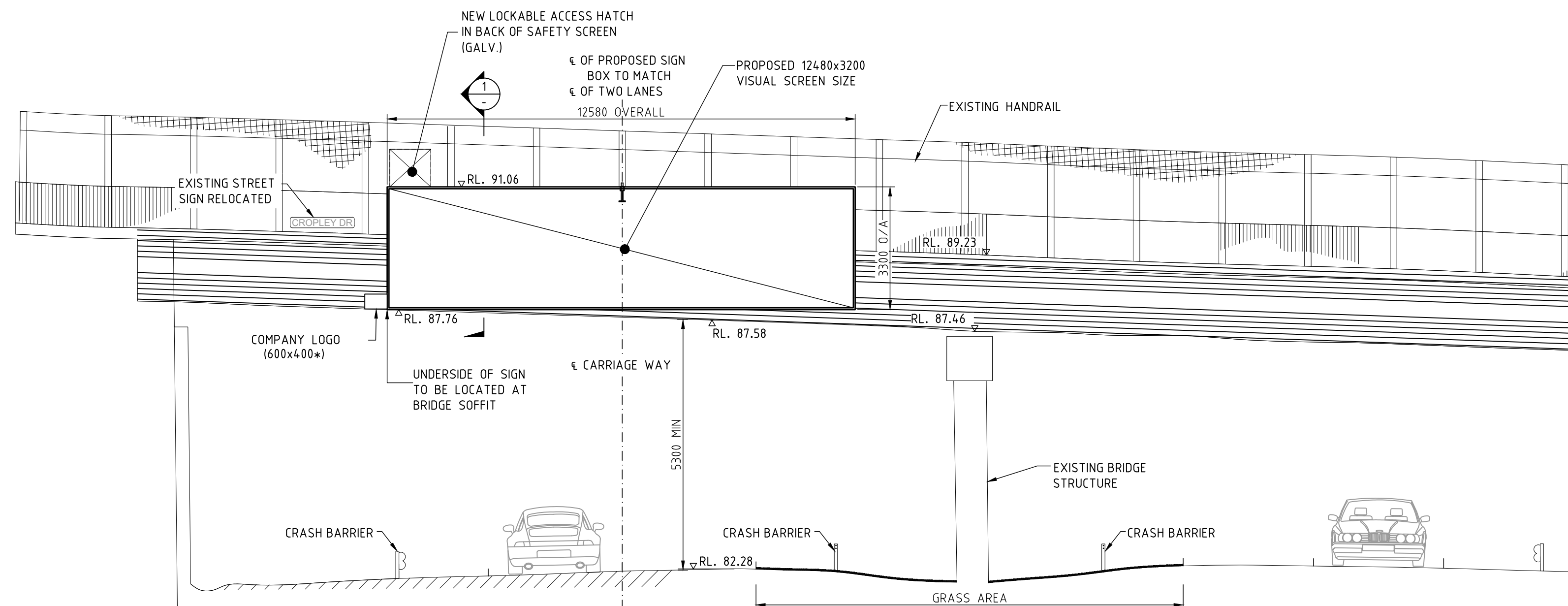

* LOGO DIMENSIONS NOMINAL

ELEVATION A
SCALE 1:100
(INBOUND)

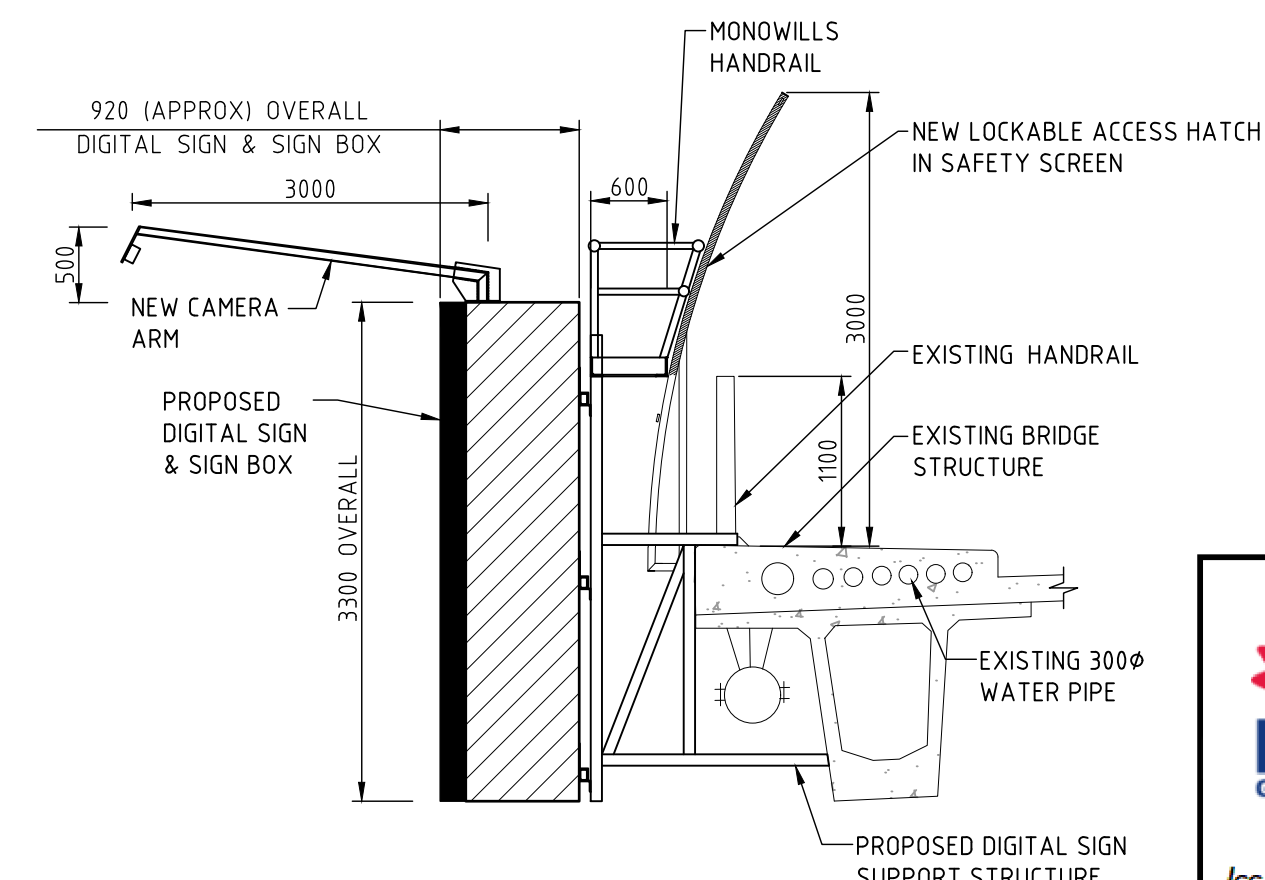

SECTION 1
SCALE 1:50



Department of Planning
and Environment

Issued under the Environmental Planning and Assessment Act 1979

Approved Application No: DA 23/2906

Granted on: 16 August 2023

Signed: R.R.

Sheet No: 1 of 1

NOT FOR CONSTRUCTION

ISS	DATE	COMMENT
A	24/08/22	ISSUED FOR APPROVAL
B	06/10/22	ISSUED FOR APPROVAL
C	17/03/23	ISSUED FOR APPROVAL
D	15/06/23	ISSUED FOR APPROVAL



Suite 4, Building 7, 49 Frenchs Forest Road East,
Frenchs Forest, NSW 2086
P.O. Box 652, Forestville, NSW 2087
Ph: 02 9451 3455 Fax: 02 9451 3466
Email: info@dbce.com.au
ABN 23 039 013 724

CLIENT:
MANBOOM

PROJECT:
CROPLEY DRIVE OVERPASS,
BAULKHAM HILLS, INBOUND & OUTBOUND

TITLE:
**PROPOSED DIGITAL SIGNS
GENERAL ARRANGEMENT &
SITE PLAN, ELEVATION &
SECTION**

DRAWN	DESIGN	DATE:
MT	JL	Aug'22
JOB NO:	DWG NO:	REV:
22141-6	DA01	D
SCALE @ A1:	AS SHOWN	REV: